



BASIC FEATURES

The **CI-RH-22DTH-11M** is an electronic sensor of relative humidity.

The sensor has an analogue voltage output 0-10V, corresponding to the range of relative air humidity 0-100%.

The humidity sensor is sensitive. Touching the sensor element or exposing it to aggressive substances like chlorine, ozone, ammonia, hydrogen peroxide or ethanol (i.e. as a cleaning agent) may affect the measurement accuracy.



PRIMARY PARAMETERS

Power source	15-24VDC, $\pm 10\%$, 0.4 W / 24AC, $\pm 10\%$, 0.8 VA
Output voltage	0-10V DC, min. resistance 10 k Ω
Measuring range	0...100% RH
Humidity measurement accuracy	$\pm 2\%$ between 0...80% RH @ 25°C
Ambient temperature / humidity	-35...50°C / Max. 95% RH, non-condensing
Electrical protection	IP65

Input voltage related to humidity

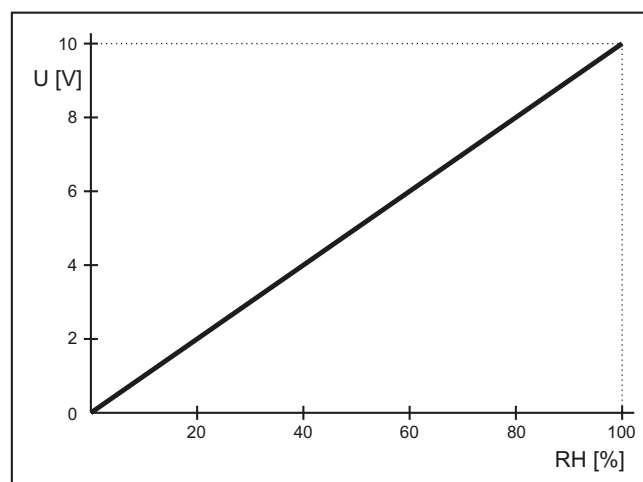

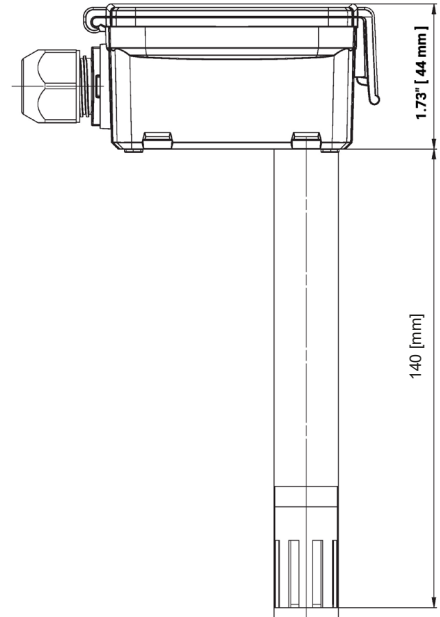
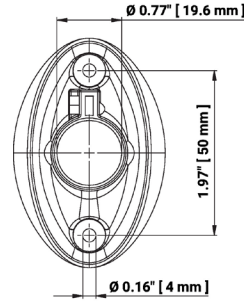
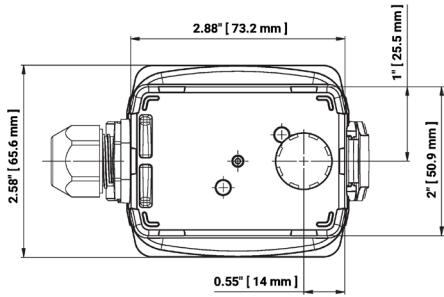

WIRING DIAGRAMS

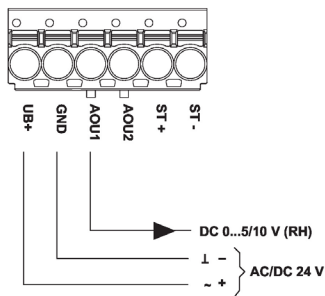

ACCESSORIES

CI-AQS-COMBI

is a signal combiner for AQS sensors using 0-10V logic which you can connect up to 10 different sensors. The input signal with the highest voltage will be the signal that is on the output terminal.



KEY TO CODING

CI-RH-22DTH-11M

Relative duct air humidity sensor